



SD4 SECURITY & BLAST DOOR

SD4 Security Doors are designed to protect medium to high risk properties from experienced attempts at forced entry, regardless of noise, using heavy hand and battery tools or explosives. Security with aesthetics.

DOOR LEAF

Thickness:	50mm
Material:	1.5mm corrosion resistant Zintec/Aluzinc sheets as standard, wide variety of colours and finishes available. Also Stainless Steel.
Infill:	Solid timber cored with internal stainless steel anti-attack skin.
Construction:	Doorblade manufactured from two 1.5mm sheets lockformed together, by bonding two steel skins around a rigid core. A total steel armour thickness of 4.5mm.
Astragal:	Blade fitted with an anti-jemmy astragal.

DOOR FRAME

Construction:	Folded and welded from 1.6mm Zintec/Aluzinc. Specially modified, variable sub-frame supplied as standard to accommodate site tolerance of -0/+30mm. The sub-frame providing additional protection to the fixings against jemmys. Fitted with stainless steel dog bolted continuous hinges for additional security.
----------------------	---

Profile:

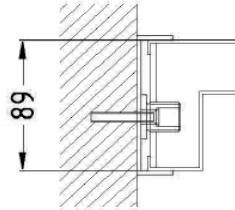

THRESHOLD

Standard:	15mm rebated threshold.
Optional:	5mm driveable (DDA compliant). 12.5mm 564A Aluminium (DDA compliant).

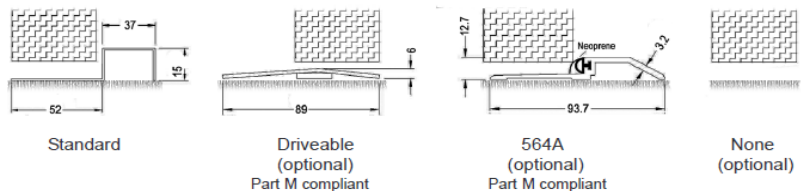

FINISHES

Standard:	Pre-primed steel (approximating to BS10A05 Goosewing Grey) requiring site painting.
Optional:	Polyester Powder Coating from standard colour range.

SIZES

Size:	Doors are custom manufactured in 10mm increments for single openings 690mm to 1390mm and double openings 1290mm to 2600mm, at heights up to 2900mm. Contact the Sales office for special configurations and finishes.
--------------	--



SD4 SECURITY & BLAST DOOR

SECURE LOCKING

Locking: A centre High Security WAAA1100 Sashlock combined with two similar Deadlocks in the upper and lower quarters of the door. All locks fitted with anti-jemmy escutcheon and welded shroud. Locks are anti-drill and pattern protected to reduce risk of key copying.

Alternatively high security multi-point panic hardware for fire escapes.

APPLICATIONS

Duty: Heavy duty and vulnerable properties, probably with a prior record of attempts at forced entry.
Protection from experienced attempts at forced entry of commercial properties with no regard for noise.

Further the door is suitable for protection against attempted entry by explosive blasts.

Note: All duty recommendations assume the doors are used in conjunction with other comparable levels of security at windows, etc.

TESTING

Tests: SECURITY Tested to prEN 1627 - 2007/09. Security Level 4.

The test involves a determined attack over a period of 30mins. using a selection of hand and battery tools including club hammer, cordless drill, cold chisel and axe. (see 'Practical Attack Element of Test for full details'.)

Locks Anti-drill tested to BS EN 1303 Security grade 6.

BLAST SD4 doors have been tested and passed EXR2 of BS EN 13124-2, the Explosion Resistance standard, with explosive blasts using plastic explosives.

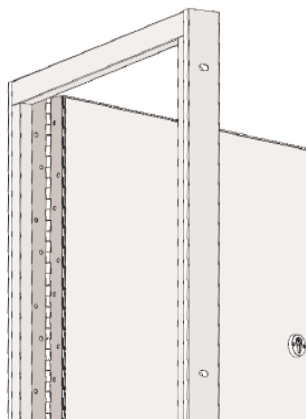

SD4 Full Height Continuous Hinge

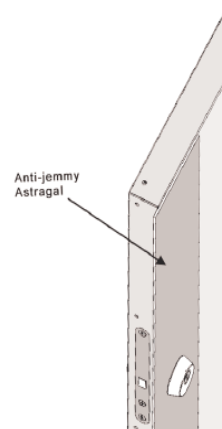

SD4 Anti-Jemmy Astragal