

**Delta Roll 3000, Manually Operated, Security Roller Shutter Door**  
**Product Data Sheet**  
**1 / 3**

**Product Description**

Our Delta Roll 3000 manual hand chain operated door is designed for areas where security is of paramount importance. The door is manually driven via a geared hauling chain mechanism mounted on either the left or right end plate.

The weight of the curtain is counterbalanced and is raised and lowered by pulling the chain in either direction. The door is locked in position by fitting the chain into the chain keep mounted at low level on the guide angle.

The door is ideally suited to applications where infrequent use is required, no power available.

**Curtain**

Constructed from 75mm wide curved section in 22SWG, 20SWG or 18SWG (over 22 Sqm), interlocking galvanised (EN10142 bright spangle) steel lath finished with a T section bottom rail. Each lath is locked together to prevent lateral movement using a nylon/steel end locks.

The curtain can be supplied in solid, perforated or a punched format. The punching can be supplied in either an inline or brick bond type format. In addition to the above tube and link curtains are available.

The above types of curtain can be supplied in either standard galvanised, powder coated or plastisol.

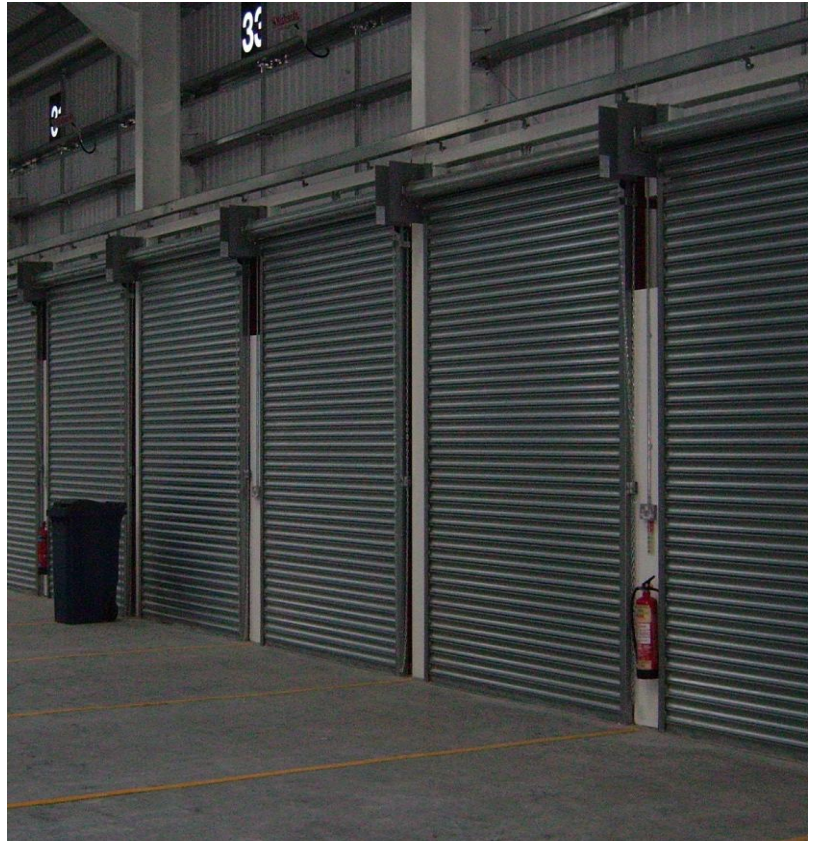

**Barrel**

Constructed from ERW steel tube mounted on a 25mm diameter steel stub shaft. Bearing blocks are fitted to each end plate to support the shaft.

Barrels incorporate helical torsion springs to counterbalance the weight of the curtain and the arrest feature is an inertia brake installed on the non-drive side where a risk assessment dictates this is required.

**Manual Operation**

Operation is by means of a galvanised chain driving through a reduction gearing.

The door is locked by placing the chain into the chain keep which can be padlocked. (padlock not provided unless specified)

A safety bearing (inertia brake) is fitted to the non – drive end of the barrel assembly in compliance with current legislation relating to the anti drop devices





## Guides

Constructed from 3mm x 63mm steel wind guide channel bolted to 75mm x 50mm steel angle. For large exposed doors, either deeper guide channels are used or wind locked guides complete with fitting steel wind locks to the curtain in addition to the end locks.

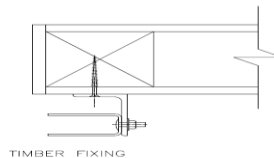
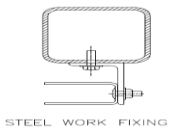
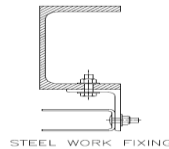
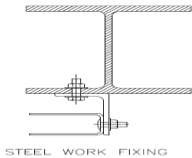
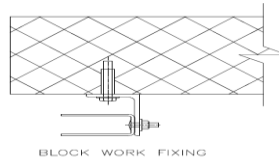
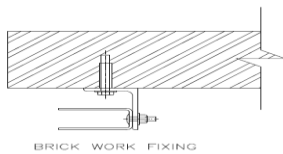

## Standard Finish

Galvanised

One coat of primer paint, on non-galvanised faces.

## Optional Extras

- Plastisol Coated Lath
- Perforated Lath
- Punched Lath
- Powder Coated
- Wicket gate
- Canopies, Fascia
- Bottom Draught Strips.
- Side Brush Seals

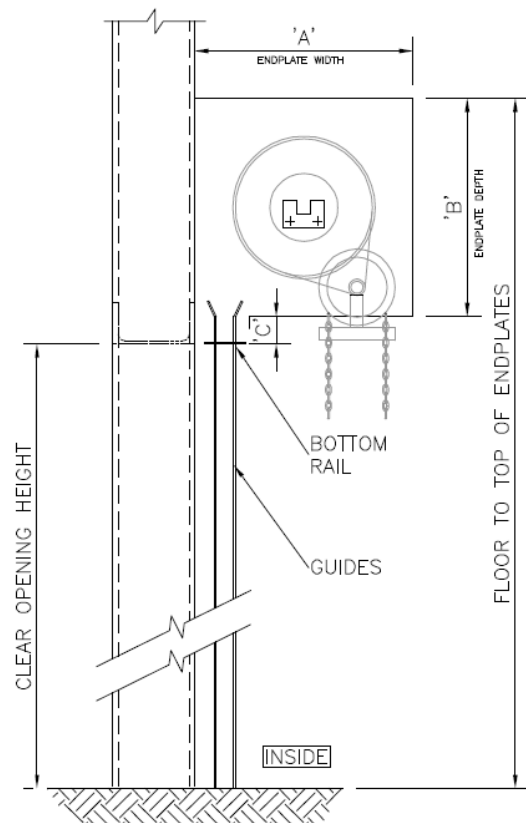
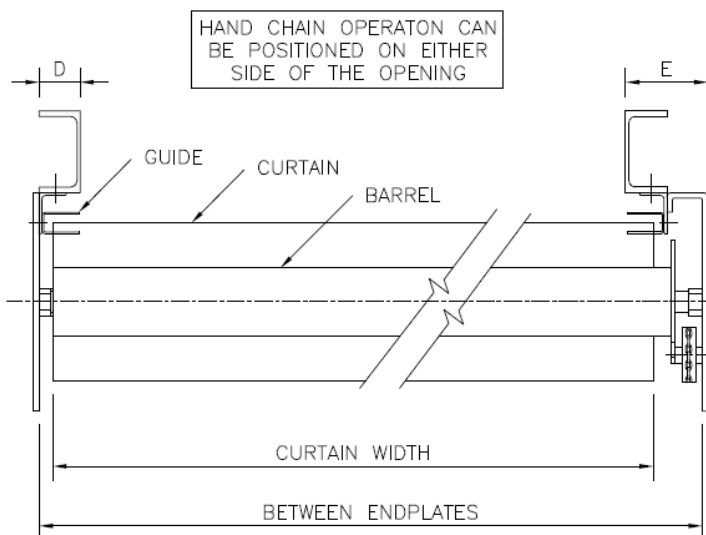
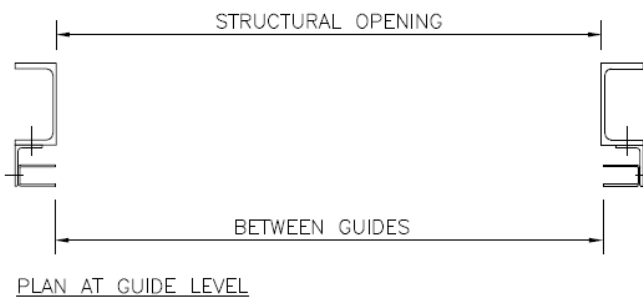

## Warranty

The Delta Roll 3000 doors are supplied with a 24 month parts and labour warranty as standard providing the equipment is maintained in accordance with the manufacturer's instruction and not modified in any way whatsoever. Full details of the servicing requirements are available.

## Servicing

To help protect your investment and extend the effective working life of the equipment, full maintenance packages are available and, in most cases, we can maintain all of your existing doors and loading bay equipment. The door must be serviced at least once per annum.

Full details of our preventative maintenance packages are available on request. Enerco recommend the first service is carried out 6 months after installation.



We have Worksafe Contractor, CHAS and Construction Line accreditation as well as being active members of the Doors and Hardware Federation (DHF) where we have their seal of approval for the service and maintenance of doors. We ensure that our staff are trained to the highest standard and all have an NVQ qualification in line with current industry guidelines. This NVQ is in addition to the CSCS Health and Safety, First Aid, Asbestos Awareness and other training including product training applicable to our industry and is continually being updated.

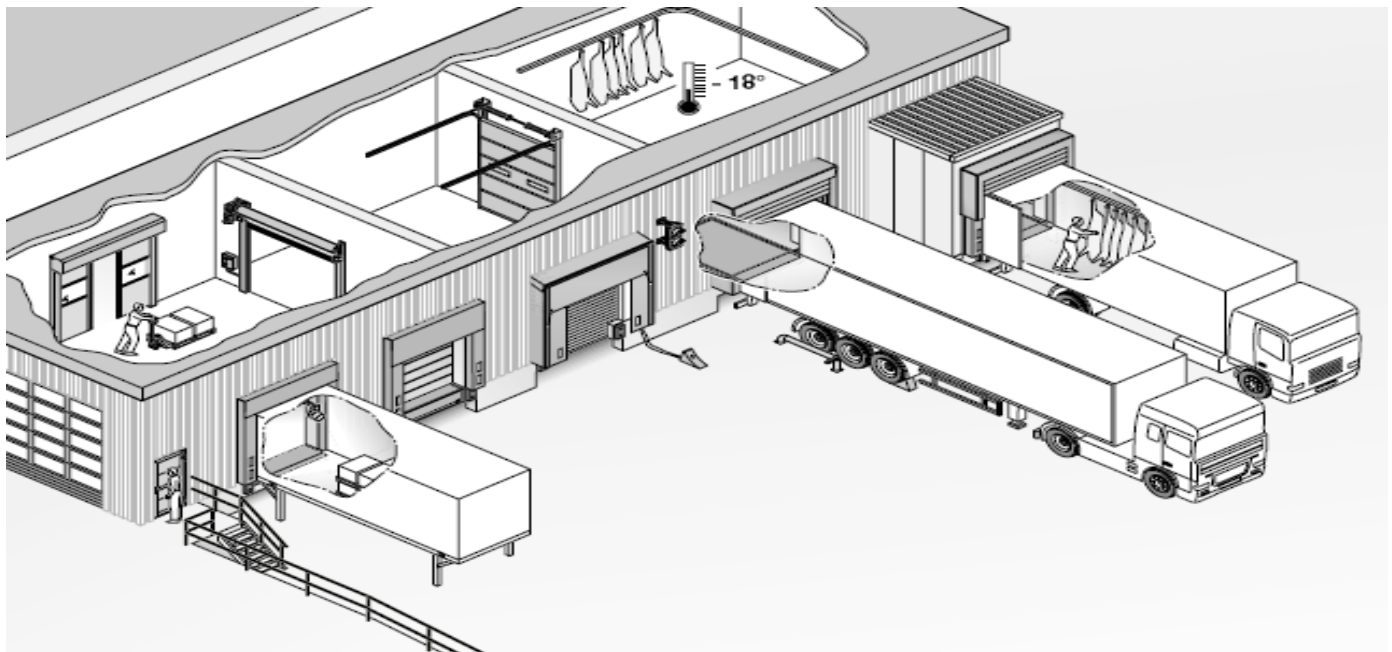

Other products in the Delta range from Enerco include: -

- |   |  |
|---|--|
| Delta Guard – Commercial Shutters           | Delta Roll – Steel Roller Shutter Doors              |
| Delta Check – Fire Roller Shutter           | Delta Secure – High Speed Security Doors             |
| Delta Slide – Insulated Overhead Doors      | Delta Insudoor – Insulated Roller Shutters           |
| Delta Part – Bi – Parting & Sliding Doors   | Delta Strip – Strip Curtains                         |
| Delta Steel – Steel Security Door Sets      | Delta Fold – Steel Sliding Folding Shutters          |
| Delta Bar – Fixed & Removable Window Bars   | Delta Lift – Scissor Lifts                           |
| Delta Seal – Dock Sealing Systems           | Delta Shield – Perimeter Security                    |
| Delta Speed – High Speed Doors              | Delta Grille – Retractable Window Grilles            |
| Delta Service – Service and Repairs         | Delta Load – Loading Bay Accessories                 |
| Delta Glide – Garage Doors                  | Delta Crash – Rubber, Polyurethane & PVC Swing Doors |
| Delta Glaze – Aluminium Glazed Door Systems |  |

Please contact our sales team for more information on 01525 289322 or a brochure. Alternatively visit our web site [www.enerco.co.uk](http://www.enerco.co.uk) or [www.enercohighspeeddoors.co.uk](http://www.enercohighspeeddoors.co.uk)

We reserve the right to change the specification or alter the product data sheet without prior notification.